

LOCATION PLAN  
 Scale 1:50,000



Scale 1:5000  
 50m 0m 100m 200m 300m 400m

KEY	
Proposed Route	
Existing Midland Metro Line 1	
Extent of Sheet	
Sheet Reference No.	1

Reproduced from the Ordnance Survey map here with permission of the Controller of Her Majesty's Stationery Office, © Crown Copyright. Licence No. LA 08914. Unauthorised reproduction infringes Crown Copyright and may lead to prosecution or civil proceedings.

Key:

- Limit of Deviation
- Limit of land to be Acquired or Used

Kerblines to be realigned between points	
A1 & A2	A3 & A4
A5 & A6	A7 & A8
A9, A9a & A10	A11, A11a & A12

Means of access to be provided or improved at point	
B	C
D	E
*	

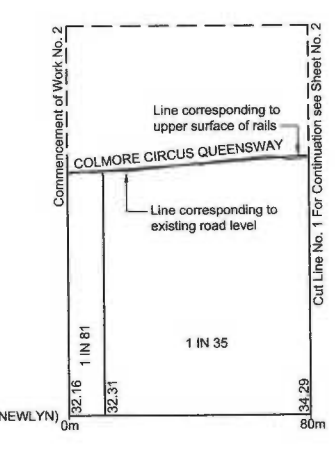
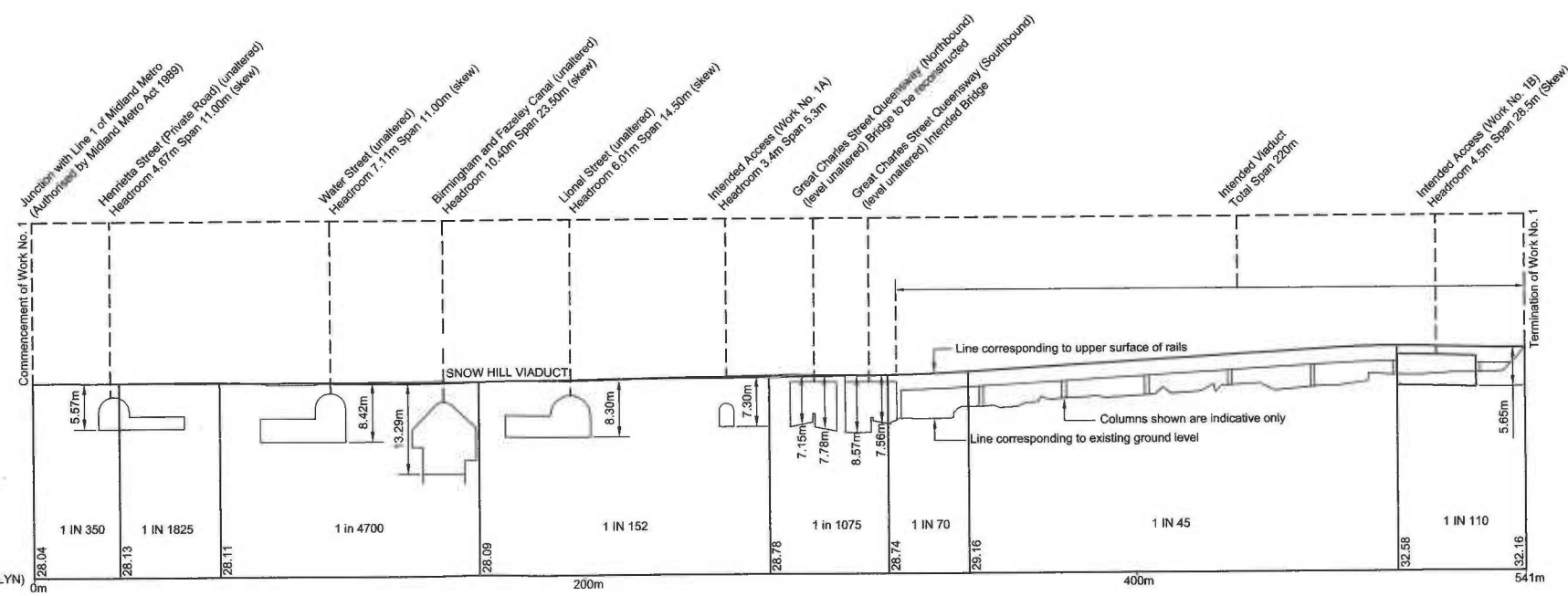
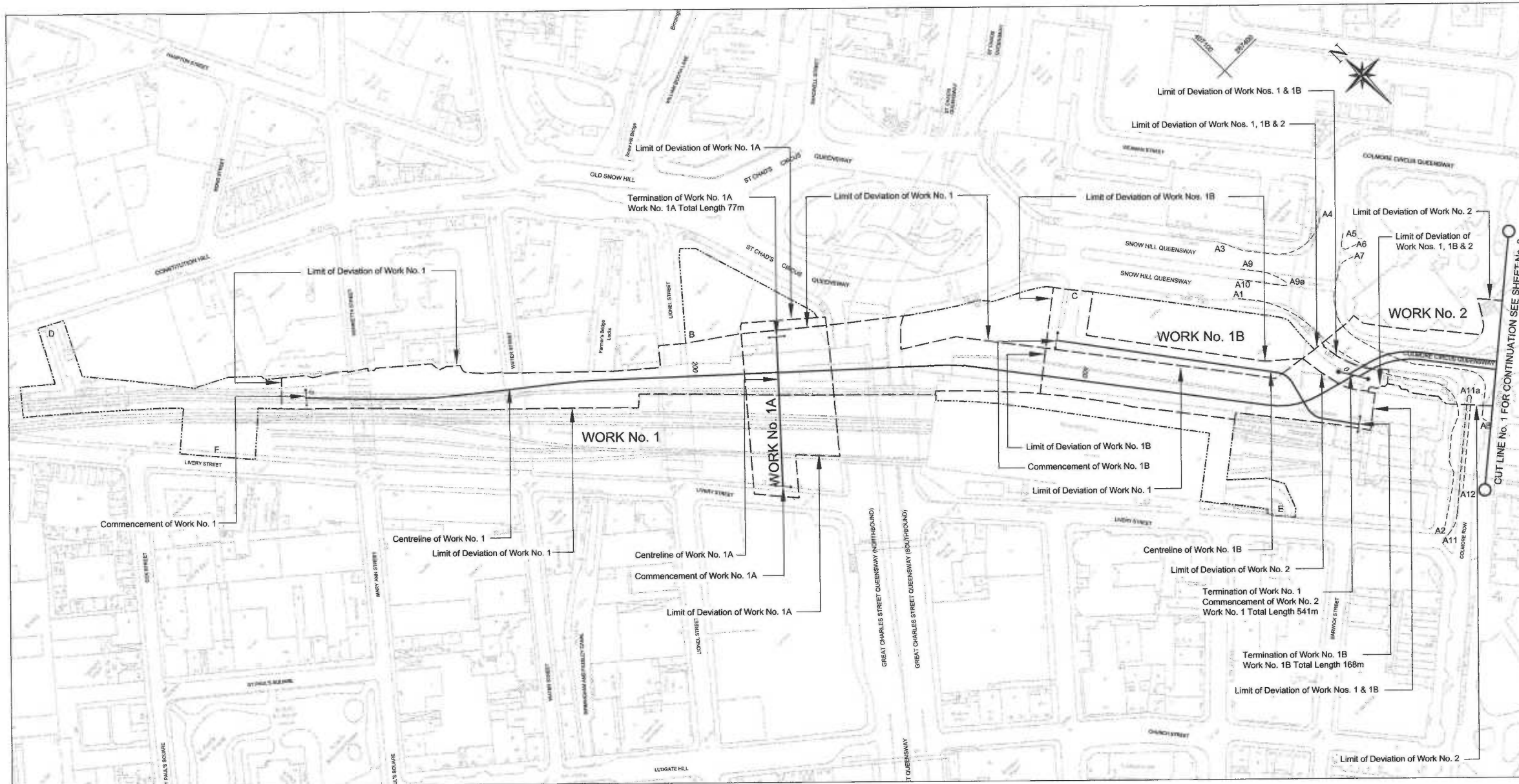

ADDITIONAL SECTIONS		
Section	Scale	Location
Work No 1A	1:1250	Sheet No 8
Work No 1A	1:500	Sheet No 7
Intended Viaduct and Great Charles Street Queensway bridge works	1:500	Sheet No 7
Work No 1B	1:1250	Sheet No 8
Work No 1B	1:500	Sheet No 7

100.0 M ABOVE  
ORDNANCE DATUM (NEWLYN)

100.0 M ABOVE  
ORDNANCE DATUM (NEWLYN)

WORK No. 1

WORK No. 2

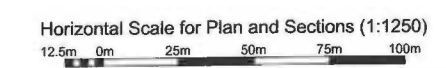

The area enclosed by any limit of deviation or by any limit of land to be acquired or used is the area extending to the outer edge of the line marking those limits.

Reproduced from the Ordnance Survey map with permission of the Controller of Her Majesty's Stationery Office & Crown Copyright. Licence No. SA 9814E. Unauthorised reproduction infringes Crown Copyright and may lead to prosecution or civil proceedings.



WORKS PLANS AND SECTIONS SHEET NO. 2

MIDLAND METRO  
(BIRMINGHAM CITY CENTRE EXTENSION, ETC.) ORDER  
CITY OF BIRMINGHAM  
WORK No. 2 (TRAMWAY)

Key:

- Limit of Deviation
- Limit of land to be Acquired or Used

Kerblines to be realigned between points	
B3 & B4	B7 & B8
B9 & B10	B11 & B12
B13 & B19	B14 & B15
B16 & B17	B18 & C1(Sht No 3)
B20 & C2(Sht No 3)	

Kerblines to be formed between points	
B1 & B2	B5 & B6
B19 & B20	

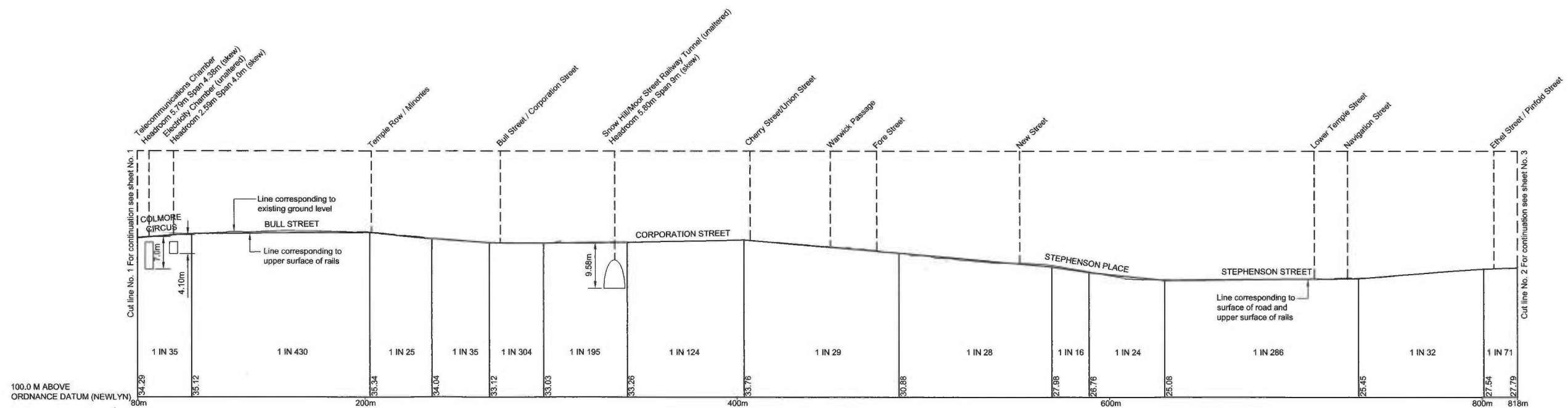
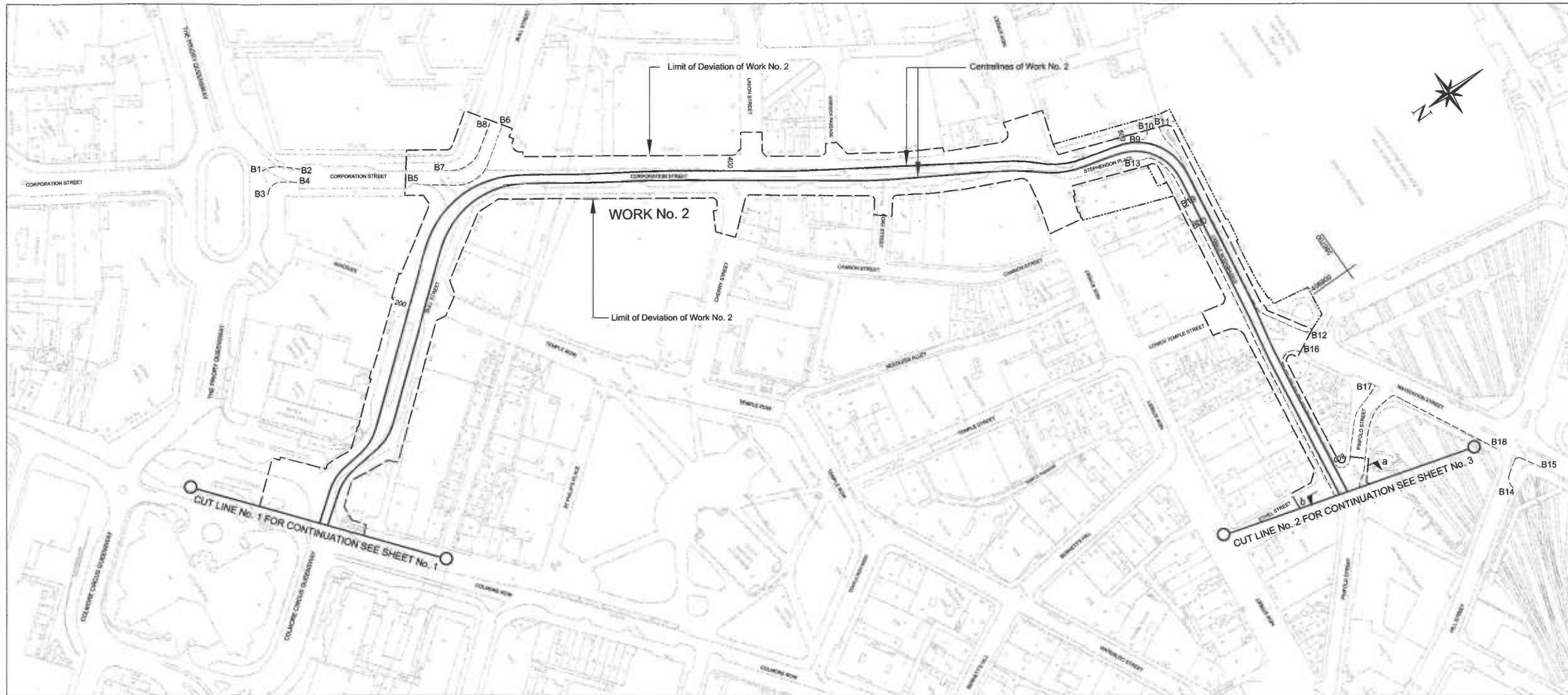

WORK No. 2

Vertical Scale for Section (1:500)  
5m 0m 10m 20m 30m 40m

Horizontal Scale for Plan and Sections (1:1250)  
12.5m 0m 25m 50m 75m 100m

The area enclosed by any limit of deviation or by any limit of land to be acquired or used is the area extending to the outer edge of the line marking those limits.

Reproduced from the Ordnance Survey map by permission of the Controller of the Map's Stationery Office. © Crown Copyright. Licence No. LA 001/16. Unauthorised reproduction infringes Crown Copyright and may lead to prosecution or civil proceedings.

MIDLAND METRO  
(BIRMINGHAM CITY CENTRE EXTENSION, ETC.) ORDER  
CITY OF BIRMINGHAM  
WORK No. 2 (TRAMWAY)  
WORK No. 2A (STREET WORKS)  
WORK No. 2B (STREET WORKS)

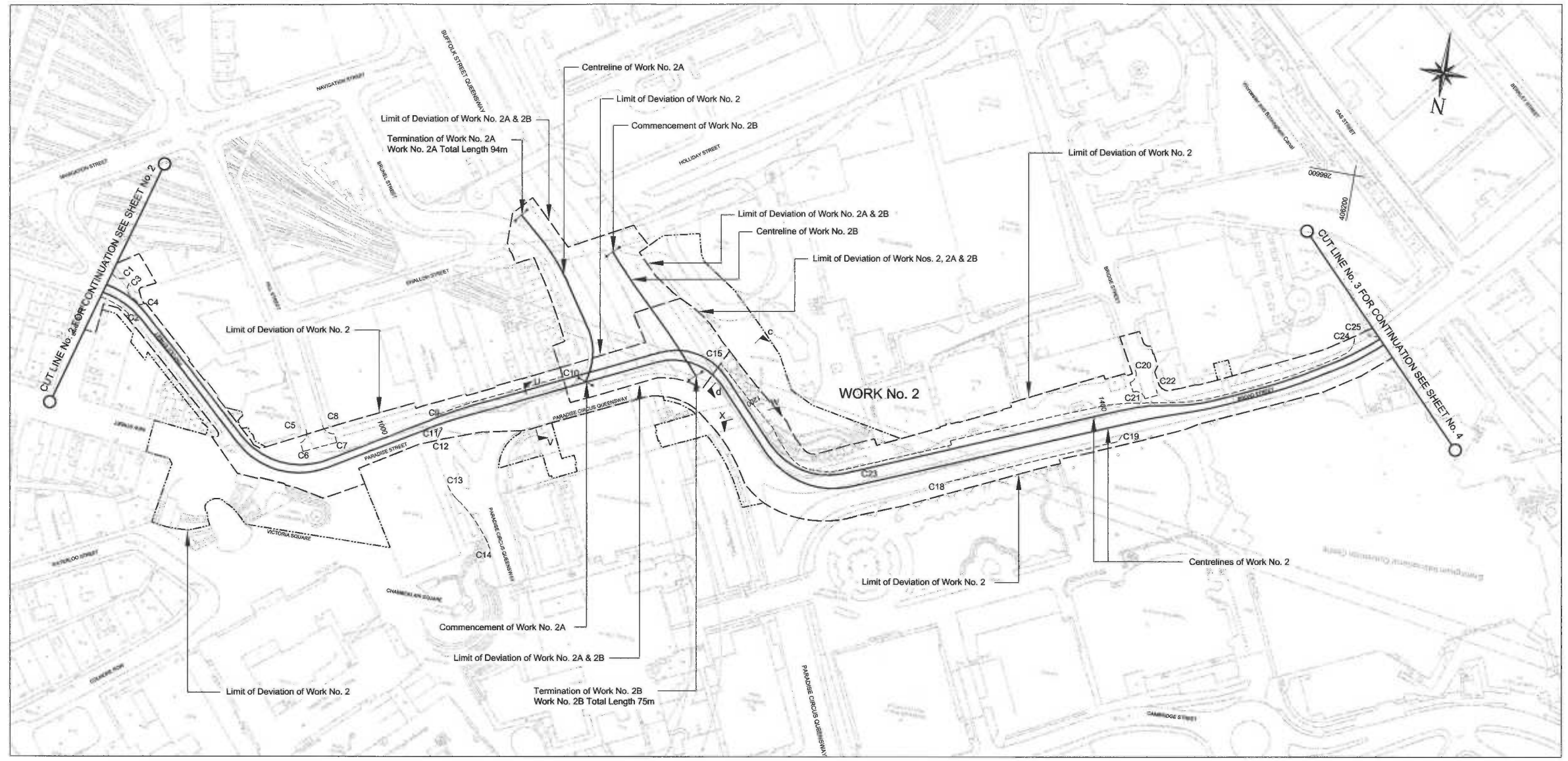

Key:  
 - - - - - Limit of Deviation  
 - . . . . - Limit of land to be Acquired or Used

Kerblines to be realigned between points	
B18(Sht No 2) & C1	B13(Sht No 2) & C2
C3 & C4	C9 & C10
C11 & C12	C13 & C14
C18 & C19	C23 & C24
C25 & D1 (Sht No 4)	
Footways to be realigned between points C15 & C23	
Vehicular access to be closed and kerblines to be formed between points	
C5, C6, C7 & C8 (Hill Street)	
C20, C21 & C22 (Bridge Street)	
Pedestrian subway to be closed between points U & V	
Pedestrian subway to be extended between points W & X	

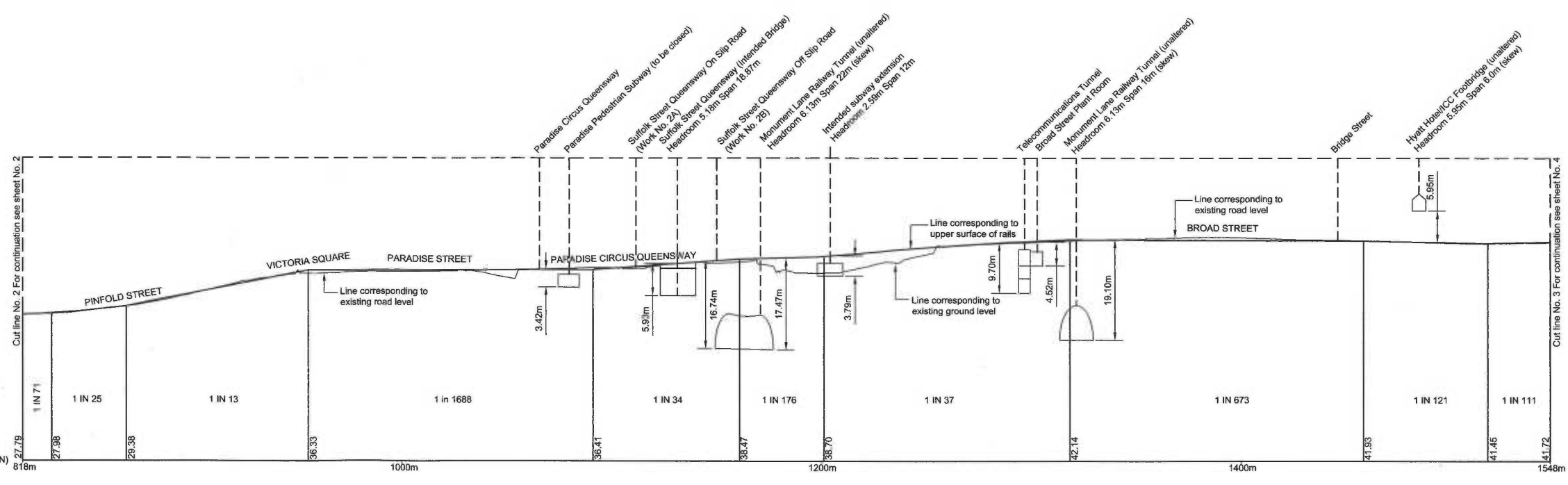

ADDITIONAL SECTIONS		
Section	Scale	Location
Work No 2A	1:1250	Sheet No 8
Work No 2A	1:500	Sheet No 7
Work No 2B	1:1250	Sheet No 8
Work No 2B	1:500	Sheet No 7
Paradise Circus Queensway (c - d)	1:500	Sheet No 7
Paradise Subway (U - V)		
Easy Row Subway (W - X)	1:500	Sheet No 8
Suffolk Street Intended Bridge	1:500	Sheet No 7

WORK No. 2



Reproduced from the Ordnance Survey map base with permission of the Controller of Her Majesty's Stationery Office. © Crown Copyright. Licence No. LA 095144. Unauthorised reproduction infringes Crown Copyright and may lead to prosecution or civil proceedings.

The area enclosed by any limit of deviation or by any limit of land to be acquired or used is the area extending to the outer edge of the line marking those limits.

MIDLAND METRO  
(BIRMINGHAM CITY CENTRE EXTENSION, ETC.) ORDER

CITY OF BIRMINGHAM

WORK No. 2 (TRAMWAY)  
WORK No. 2C (STREET WORKS)

Key:

- Limit of Deviation
- - - - - Limit of land to be Acquired or Used

Kerblines to be realigned between joints	
C25 (Sht No 3) & D1	D3 & D4
D5 & D6	D7 & D18
D11 & D14	D15 & D24
D19 & D20	D25, D25a & D26
D27, D27a & D28	D29, D29a & D30
D32 & D33	D34 & D35
D36 & D37	D38 & D39
D40 & D41	

Means of access to be provided or improved at point	
G	H
I	J

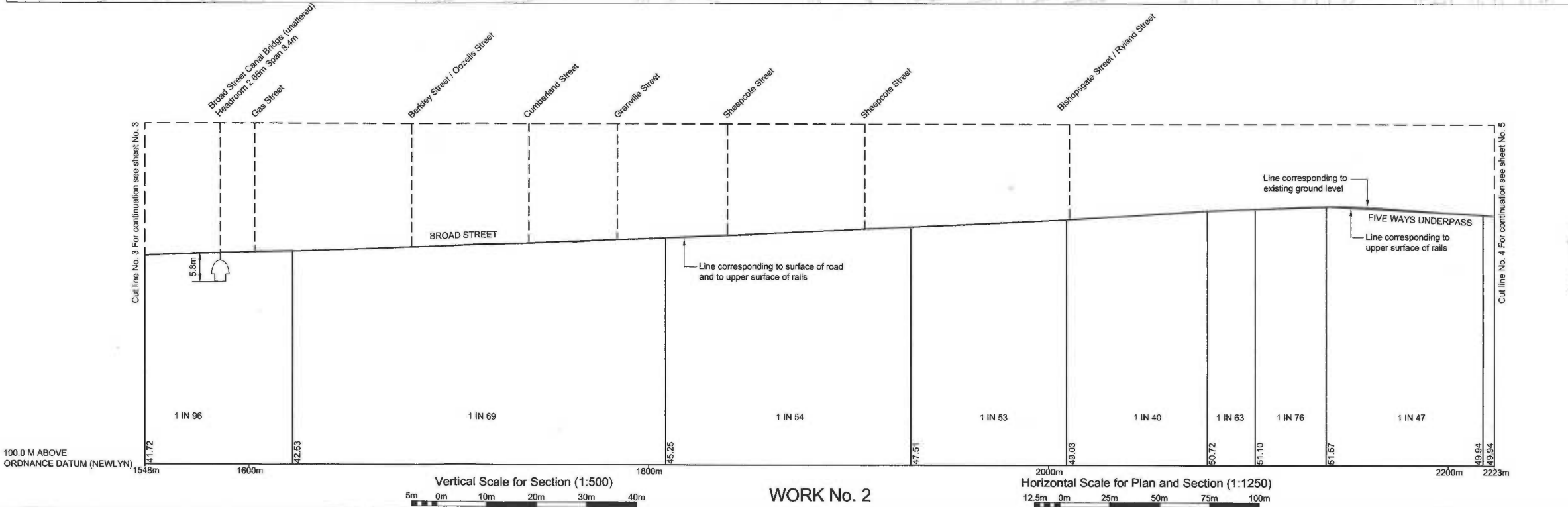
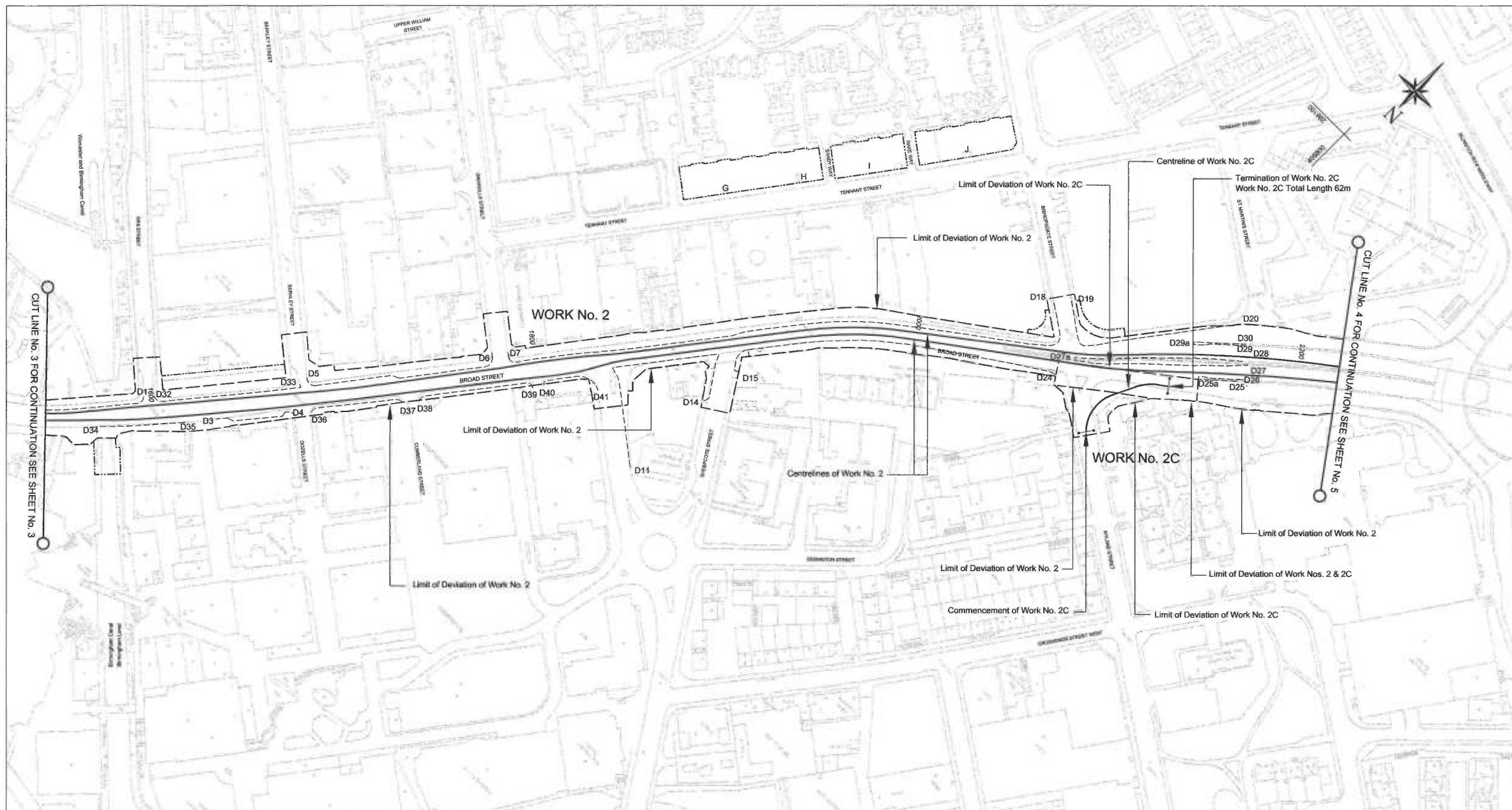

ADDITIONAL SECTIONS		
Section	Scale	Location
Work No 2C	1:1250	Sheet No 8
Work No 2C	1:500	Sheet No 8

Reproduced from the Ordnance Survey map, best with permission of the Controller of Her Majesty's Stationery Office, © Crown Copyright. License No. 1A 08916. Unauthorised reproduction infringes Crown Copyright and may lead to prosecution or civil proceedings.

The area enclosed by any limit of deviation or by any limit of land to be acquired or used is the area extending to the outer edge of the line marking those limits.

WORK No. 2